



K-Class Benchmark in technology and design



The Open World of Finest Weighing Solutions. Since 1866.

Our experience sets standards

We are a family-owned company guided by a commitment to tradition, sustainability and responsibility. Nowadays, based on our core competence of slicing and weighing technology, we offer our customers the industry's largest and most unique range of products and solutions as hardware, software and services, anywhere in the world.

As a globally operating technology company we are guided by our goal and commitment to achieve maximum results in terms of ergonomic design, hygiene, safety and efficiency. We believe we have a role to play in shaping our markets, and are continually setting new industry standards.

In close collaboration with our customers and against a backdrop of technological advancement, we are working to improve our products on a daily basis - resulting in innovations which become new standards.

In order to continue to live up to these requirements, we focus on the highest possible quality standards and internationally recognized technology standards in our development and manufacturing work. This is how we best support our customers in achieving maximum efficiency and profitable growth.

Our experience sets standards.
That's what sets us apart. Bizerba



Efficiency and investment security

With the K-Class, we have not only developed a visually impressive scale which achieves the perfect combination of design and functionality.

By using high-quality materials in such an aesthetically pleasing and ergonomic way, we have once again set standards – just as we do by consistently applying the principles of open weighing technology.

As one of the most powerful touchscreen scales in the world, the K-Class represents the pinnacle of efficient use of technology as well as long-term investment security.

The K-Class brings together all essential retail tasks – weighing, transactions, promotions, printing, advising – it's all possible. And everything is done so smoothly and reliably that it is hard to imagine a more satisfactory tool for daily operations.

Based on a uniform, modular design and available in a wide range of different models and options, the K-Class is a prime example of technical feasibility meeting economic sense.

K-Class KH II 800



Easy Clean

- Frameless display
- Structured housing surface
- Very easy to clean
- Insensitive to dirt, fingerprints, labels and traces of use
- Long-lasting flawless appearance



Green IT

- High performance at low level of power consumption (no fan)
- Economical components (SSD, LED backlit)
- High efficiency power supply unit
- Wake on Lan



Inner values

- Modern Intel® Dual Core processor
- Fast SSD memories, DDR3 RAM
- Fast graphics
- High speed interfaces



Easy Load

- Quick and easy inserting of paper on receipt / linerless printer
- Paper width up to 80 mm, roll length up to 80 m, print speed up to 150 mm/s
- Printing of label layouts on pre-printed linerless paper



Software*

- Platform for:
- RetailPowerScale
 - RetailFramework
 - RetailApps
 - RetailIntegratorsKit



Easy Level*

- Recognition of angled scale position
- Automatic weight value correction
- No loss in sales due to inclined scale

The K-Class touchscreen scale is the yardstick for the service counter. It is a key step towards intelligent technology, which takes care of standard activities and hence noticeably lightens a sales employee's workload: it automatically improves the competence and performance of the person behind the counter.

Thanks to the software on the inside, the devices can be customized to handle an immense range of tasks. And that is precisely the aim of Bizerba's engineers: to develop solutions which go a step further than all the others - solutions which deliver convincing performance and are remarkably simple to work with. Technology which is hygienically clean, ensures maximum safety and yet has extremely low requirements in terms of electricity, care and maintenance.

* optional

The fruits of our labor



Easy Clean

To help you save time and money when cleaning the K-Class we have used dirt-resistant, extremely stable and anti-corrosion surfaces. They comply with the strictest international hygiene requirements. Stray labels and stubborn residues can be removed from the innovative surface easily and problem-free.

Customer and operator display are seamlessly integrated in the housing to form a completely smooth transition between housing and screen. Otherwise hard-to-remove dirt can no longer accumulate here. As a result, the Easy Clean displays not only look particularly stylish but also offer a number of important practical benefits.

Inner values

The integration of a computer with a special high-performance Intel® processor proves that these systems should not be called just scales, but PCs with weighing function. The Bizerba RetailPowerScale software transforms the IT-supported weighing system into a digital, multifunctional workstation. Thanks to its numerous interfaces, the K-Class is easy to integrate into your IT network and device landscape.

RetailPowerScale software

RetailPowerScale provides the all-in-one solution for the retail trade. Whether a scale is used by specialty food stores or top 100 retailers – RetailPowerScale is the key to turn your PC scale into a multifunctional device. Additional functions are easily and quickly available via modular RetailApps. Highly scalable in the required functionality, adaptable to the last detail in the layout. Individuality is combined with the advantages of standard software which seamlessly integrates in existing IT infrastructure.

Lower operating costs while increasing sales: RetailPowerScale makes it possible. The sophisticated use of operator display and a customer display which can be separately addressed opens up new opportunities in sales at the point of service.

RetailApps

RetailApps are true masters in flexibility, adapting to meet specific market requirements. They are separate, self-contained solutions that are easily docked on to the scale software RetailPowerScale via standardized interfaces. The advantages are clear: less development time, lower costs and investment protection thanks to care and maintenance. Existing RetailApps such as EasyOrder and IngredientManager are immediately available and ready for operation and their solution portfolio is growing constantly.

Easy Level

Easy Level is an automatic tilt compensation eliminating weighing errors. These can otherwise be commonplace, such as when the scale is in mobile use or is placed on an un-level surface. Thanks to the Easy Level technology, the tilt angle is measured and compensated automatically, thus guaranteeing that the correct weight value is displayed. Conclusion: A correct weight despite tilt means no loss of revenue.

Easy Load

A printer that really does its name justice – because although it can handle virtually all standard types of paper, the rolls can be exchanged amazingly quickly. Whether two or three inch rolls, with a paper width of up to 80 millimeters for receipt operation or linerless paper and label operation – everything is possible and saves valuable time thanks to convenient operation. Plus the double printer allows the customer to use different types of paper simultaneously.

Black or White

Our K-Class: Well-balanced model offering maximum performance. Attractive appearance, technically brilliant functions. In timeless white or exclusive black. One more possibility to integrate your Bizerba scale in your design concept in an individual and harmonious manner. Pick the color of your choice!



Discover new perspectives

With Augmented Reality (AR) this brochure offers you additional digital information on the Bizerba product which you will get to know from all perspectives on the following pages. Merging print and digital medium makes it possible. And this is how it works:

Load our free Bizerba AR app from the App store (Apple) or Play-Store (Google). The download works even faster via scan.



Apple devices



Android devices



Open and use the app wherever you see the Bizerba AR logo.



BIZERBA

Point the camera of your smartphone or tablet* at the AR logo.



BIZERBA

*The Bizerba app is optimized for the latest smartphone and tablet generations. Older devices with a less powerful processor could have problems to display the AR contents.



KH II 800 12,1"



KH II 800 12,1"

Highlights

- Countertop scale, ideally suitable for assisted sales in the fresh food area
- Easy Clean for quick and easy cleaning of the scale
 - Surface: problem-free removal of stray labels
 - Displays: frameless for ease of cleaning
 - Load platter: optimum ease of handling
- Easy Load enables paper rolls to be changed in a matter of seconds
 - Combi-printer with receipt and linerless operation up to 80 mm paper roll widths
 - Additional label layout possible on preprinted linerless paper
- Label and dual printer
- Easy Level tilt compensation
 - Accurate weighing results even when the scale is not leveled, no loss of revenue
- High-end PC scale with outstanding Intel® Dual Core processor for optimum performance and perfect graphics with minimum power consumption
- Wake on LAN for more energy efficiency

Options

- Easy Level tilt compensation
- Dual printer
- Various weighing ranges
- Additional COM interface in conjunction with interface for cash drawer
- Cash register drawer
- WLAN
- Audio kit (internal speaker)
- High-end Bizerba software package
- RetailPowerScale scale software
- RetailApps for additional functionality
- RetailFramework
- RetailIntegratorsKit (RIK) for 3rd-party software

Dimensions

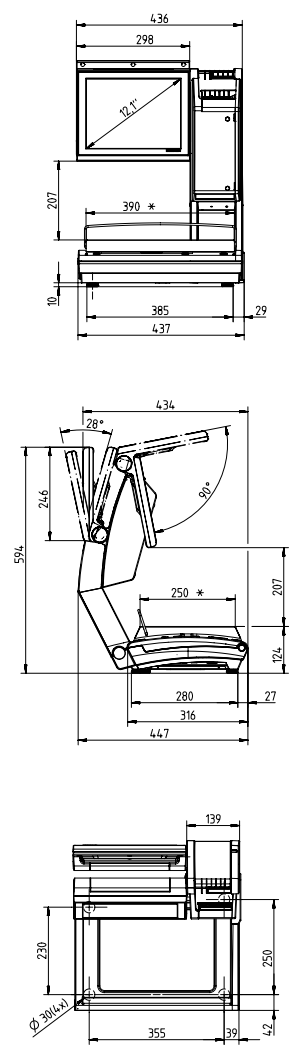

KH II 800 7"

Highlights

- Countertop scale, ideally suitable for assisted sales in the fresh food area
- Easy Clean for quick and easy cleaning of the scale
 - Surface: problem-free removal of stray labels
 - Displays: frameless for ease of cleaning
 - Load platter: optimum ease of handling
- Easy Load enables paper rolls to be changed in a matter of seconds
 - Combi-printer with receipt and linerless operation up to 80 mm paper roll widths
 - Additional label layout possible on preprinted linerless paper
- Label and dual printer
- Easy Level tilt compensation
 - Accurate weighing results even when the scale is not leveled, no loss of revenue
- High-end PC scale with outstanding Intel® Dual Core processor for optimum performance and perfect graphics with minimum power consumption
- Wake on LAN for more energy efficiency

Options

- Easy Level tilt compensation
- Dual printer
- Various weighing ranges
- Additional COM interface in conjunction with interface for cash drawer
- Cash register drawer
- WLAN
- Audio kit (internal speaker)
- High-end Bizerba software package
- RetailPowerScale scale software
- RetailApps for additional functionality
- RetailFramework
- RetailIntegratorsKit (RIK) for 3rd-party software

Dimensions

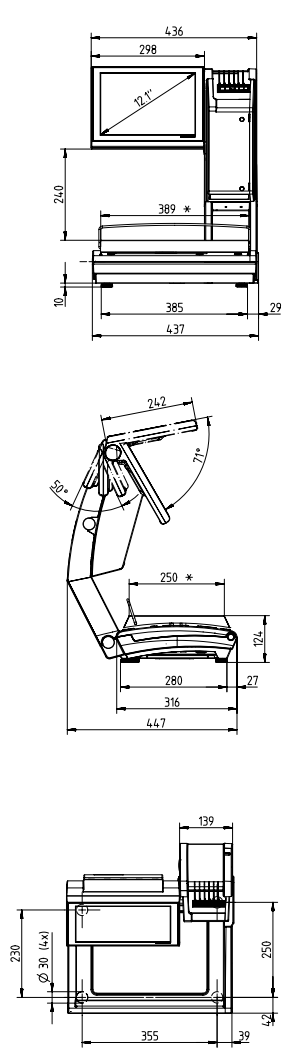

KH II 800 7"



KH II 800^{SB}

Highlights

- Ideally suitable for self-service (SB)
- Easy Clean for quick and easy cleaning of the scale
 - Surface: problem-free removal of stray labels
 - Displays: frameless for ease of cleaning
- Load platter: easy handling
- Easy Load enables label rolls to be changed in a matter of seconds
- Combi-printer with receipt and linerless operation up to 80 mm paper roll widths
- In addition label layout on pre-printed linerless paper possible
- Label printer
- Easy Level tilt compensation
 - Correct weight even at an angled position, no loss of sales
- High-end PC scale with outstanding Intel® Dual Core processor for optimum performance and perfect graphics with minimum power consumption
- Wake on LAN for more energy efficiency

Options

- Easy Level tilt compensation
- Various weighing ranges
- Additional COM interface in conjunction with interface for cash drawer
- Cash register drawer
- WLAN
- Audio kit (internal speaker)
- High-end Bizerba software package
 - RetailPowerScale scale software
 - RetailApps for additional functionality
 - RetailFramework
 - RetailIntegratorsKit (RIK) for 3rd-party software

Dimensions

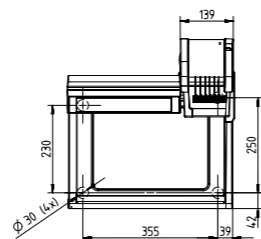
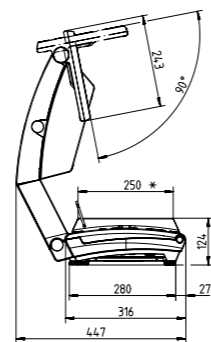
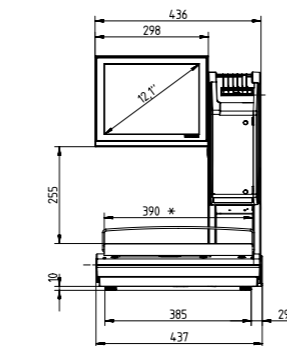

KH II 800^{SV}

Highlights

- Self-service scale with camera for article recognition (SV), ideally suitable for fruit and vegetables
- Easy Clean for quick and easy cleaning of the scale
 - Surface: problem-free removal of stray labels
 - Displays: frameless for ease of cleaning
- Load platter: easy handling
- Easy Load enables label rolls to be changed in a matter of seconds
- Combi-printer with receipt and linerless operation up to 80 mm paper roll widths
- In addition label layout on pre-printed linerless paper possible
- Label printer
- Easy Level tilt compensation
 - Correct weight even at an angled position, no loss of sales
- High-end PC scale with outstanding Intel® Dual Core processor for optimum performance and perfect graphics with minimum power consumption
- Wake on LAN for more energy efficiency

Options

- Easy Level tilt compensation
- Various weighing ranges
- Additional COM interface in conjunction with interface for cash drawer
- Cash register drawer
- WLAN
- Audio kit (internal speaker)
- High-end Bizerba software package
 - RetailPowerScale scale software
 - RetailApps for additional functionality
 - RetailFramework
 - RetailIntegratorsKit (RIK) for 3rd-party software

Dimensions

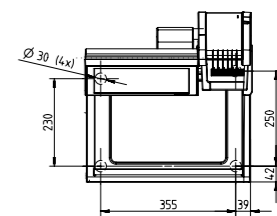
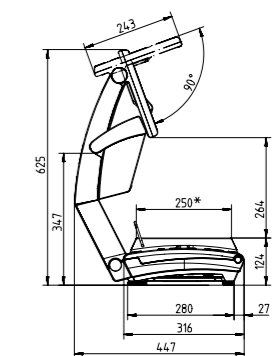
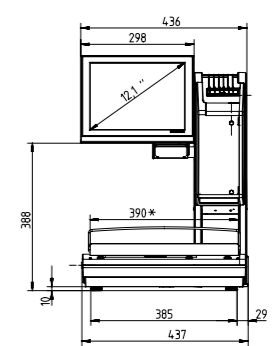



KH II 800 12,1" SP

Highlights

- Very compact solution with a short stand (SP). Ideal for a cash register drawer.
- Easy Clean for quick and easy cleaning of the scale
 - Surface: problem-free removal of stray labels
 - Displays: frameless for ease of cleaning
- Load platter: easy handling
- Easy Load enables label rolls to be changed in a matter of seconds
 - Combi-printer with receipt and linerless operation up to 80 mm paper roll widths
 - In addition label layout on pre-printed linerless paper possible
- Label and dual printer
- Easy Level tilt compensation
 - Correct weight even at an angled position, no loss of sales
- High-end PC scale with outstanding Intel® Dual Core processor for optimum performance and perfect graphics with minimum power consumption
- Wake on LAN for more energy efficiency

Options

- Easy Level tilt compensation
- Dual printer
- Various weighing ranges
- Additional COM interface in conjunction with interface for cash drawer
- Cash register drawer
- WLAN
- Audio kit (internal speaker)
- High-end Bizerba software package
 - RetailPowerScale scale software
 - RetailApps for additional functionality
 - RetailFramework
 - RetailIntegratorsKit (RIK) for 3rd-party software

Dimensions

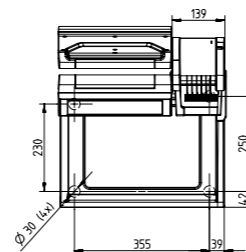
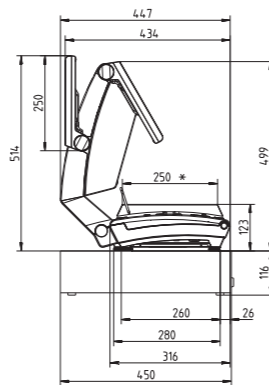
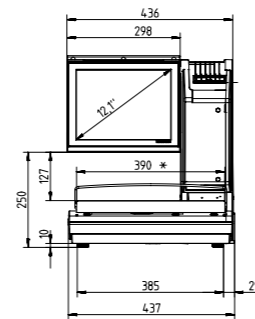

KH II 800 TP

Highlights

- Flexible due to dual printer (TP)
- Easy Clean for quick and easy cleaning of the scale
 - Surface: problem-free removal of stray labels
 - Displays: frameless for ease of cleaning
- Load platter: easy handling
- Easy Load enables label rolls to be changed in a matter of seconds
 - Two printers: 3" label printer plus 3" label printer
 - Two printers: 2" receipt/linerless printer plus 3" label printer
- Easy Level tilt compensation
 - Correct weight even at an angled position, no loss of sales
- High-end PC scale with outstanding Intel® Dual Core processor for optimum performance and perfect graphics with minimum power consumption
- Wake on LAN for more energy efficiency

Options

- Easy Level tilt compensation
- Various weighing ranges
- Additional COM interface in conjunction with interface for cash drawer
- Cash register drawer
- WLAN
- Audio kit (internal speaker)
- High-end Bizerba software package
 - RetailPowerScale scale software
 - RetailApps for additional functionality
 - RetailFramework
 - RetailIntegratorsKit (RIK) for 3rd-party software

Dimensions

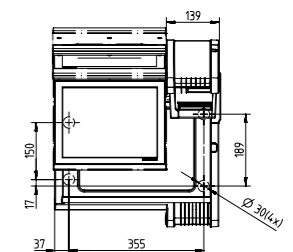
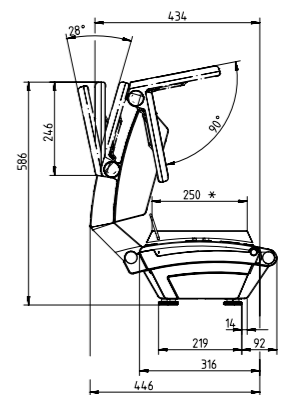
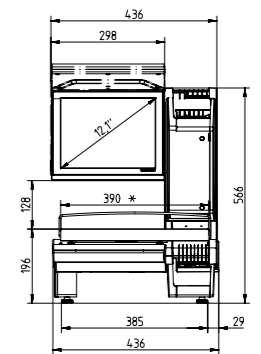



KH II 400 12,1"

Highlights

- Hanging scale, specifically for the fish counter
- Easy Clean for quick and easy cleaning of the scale
 - Surface: problem-free removal of stray labels
 - Displays: frameless for ease of cleaning
- Weighing tray/pan: easy handling
- Easy Load enables label rolls to be changed in a matter of seconds
- Combi-printer with receipt and linerless operation up to 80 mm paper roll widths
- In addition label layout on pre-printed linerless paper possible
- Label and dual printer
- High-end PC scale with outstanding Intel® Dual Core processor for optimum performance and perfect graphics with minimum power consumption
- Wake on LAN for more energy efficiency

Options

- Dual printer
- Various weighing ranges
- Additional COM interface in conjunction with interface for cash drawer
- Cash register drawer
- WLAN
- Audio kit (internal speaker)
- High-end Bizerba software package
 - RetailPowerScale scale software
 - RetailApps for additional functionality
 - RetailFramework
 - RetailIntegratorsKit (RIK) for 3rd-party software

Dimensions

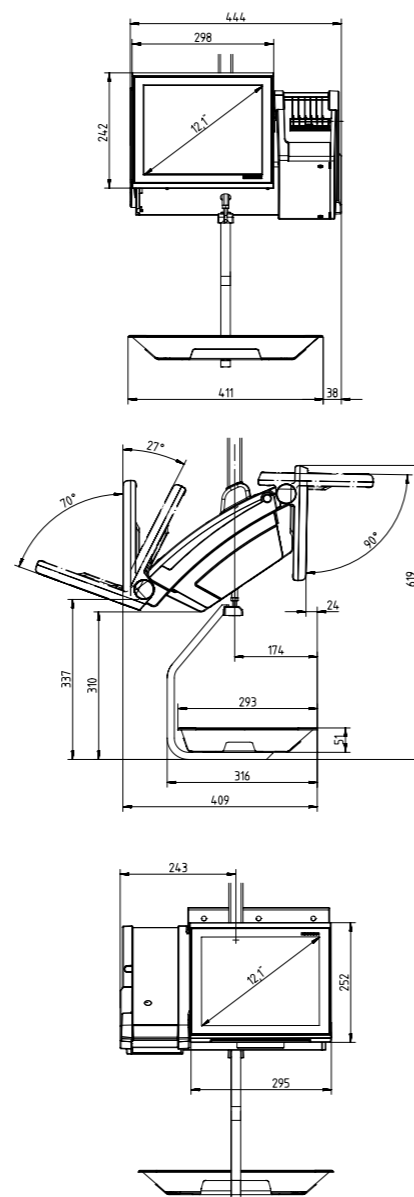

BIZERBA



KH II 400 7"

Highlights

- Hanging scale, specifically for the fish counter
- Easy Clean for quick and easy cleaning of the scale
 - Surface: problem-free removal of stray labels
 - Displays: frameless for ease of cleaning
- Weighing tray/pan: easy handling
- Easy Load enables label rolls to be changed in a matter of seconds
- Combi-printer with receipt and linerless operation up to 80 mm paper roll widths
- In addition label layout on pre-printed linerless paper possible
- Label and dual printer
- High-end PC scale with outstanding Intel® Dual Core processor for optimum performance and perfect graphics with minimum power consumption
- Wake on LAN for more energy efficiency

Options

- Dual printer
- Various weighing ranges
- Additional COM interface in conjunction with interface for cash drawer
- Cash register drawer
- WLAN
- Audio kit (internal speaker)
- High-end Bizerba software package
 - RetailPowerScale scale software
 - RetailApps for additional functionality
 - RetailFramework
 - RetailIntegratorsKit (RIK) for 3rd-party software

Dimensions

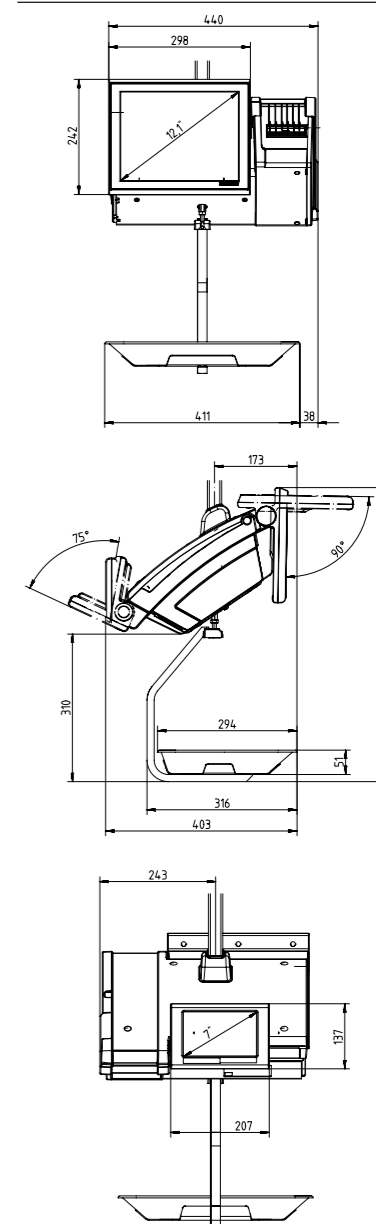

BIZERBA



KH II 200 12,1"

Highlights

- Countertop scale, ideally suitable for assisted sales in the fresh food area
- Easy Clean for quick and easy cleaning of the scale
 - Surface: problem-free removal of stray labels
 - Displays: frameless for ease of cleaning
- Weighing tray/pan: easy handling
- Easy Load enables label rolls to be changed in a matter of seconds
 - Combi-printer with receipt and linerless operation up to 80 mm paper roll widths
 - In addition label layout on pre-printed linerless paper possible
- Label printer
- Easy Level tilt compensation
 - Correct weight even at an angled position, no loss of sales
- High-end PC scale with outstanding Intel® Dual Core processor for optimum performance and perfect graphics with minimum power consumption
- Wake on LAN for more energy efficiency

Options

- Easy Level tilt compensation
- Various weighing ranges
- Additional COM interface in conjunction with interface for cash drawer
- Cash register drawer
- WLAN
- Audio kit (internal speaker)
- High-end Bizerba software package
 - RetailPowerScale scale software
 - RetailApps for additional functionality
 - RetailFramework
 - RetailIntegratorsKit (RIK) for 3rd-party software

Dimensions

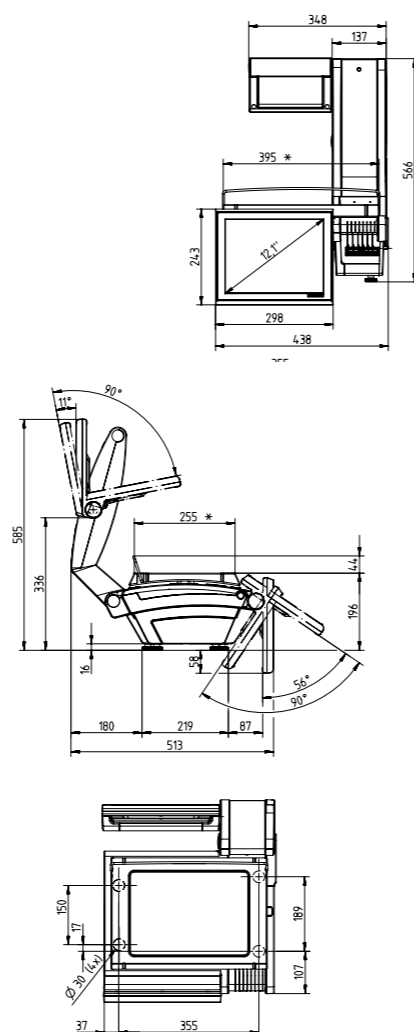

KH II 200 7"

Highlights

- Countertop scale, ideally suitable for assisted sales in the fresh food area
- Easy Clean for quick and easy cleaning of the scale
 - Surface: problem-free removal of stray labels
 - Displays: frameless for ease of cleaning
- Weighing tray/pan: easy handling
- Easy Load enables label rolls to be changed in a matter of seconds
 - Combi-printer with receipt and linerless operation up to 80 mm paper roll widths
 - In addition label layout on pre-printed linerless paper possible
- Label printer
- Easy Level tilt compensation
 - correct weight even at an angled position, no loss of sales
- High-end PC scale with outstanding Intel® Dual Core processor for optimum performance and perfect graphics with minimum power consumption
- Wake on LAN for more energy efficiency

Options

- Easy Level tilt compensation
- Various weighing ranges
- Additional COM interface in conjunction with interface for cash drawer
- Cash register drawer
- WLAN
- Audio kit (internal speaker)
- High-end Bizerba software package
 - RetailPowerScale scale software
 - RetailApps for additional functionality
 - RetailFramework
 - RetailIntegratorsKit (RIK) for 3rd-party software

Dimensions

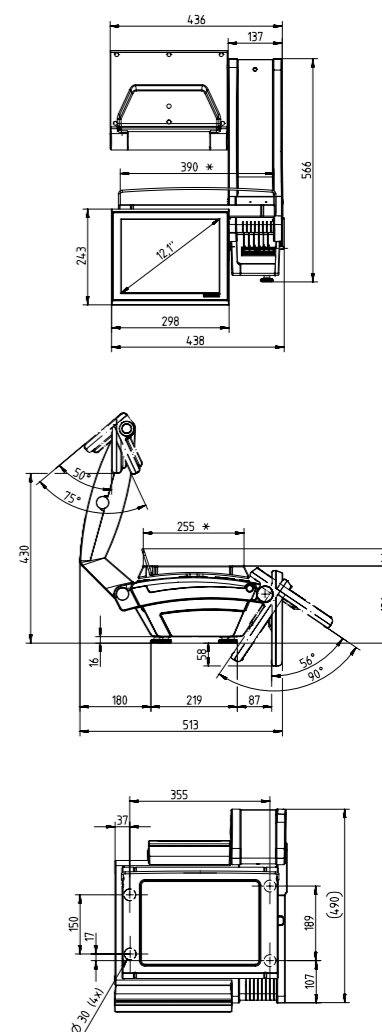



KH II 100 7"

Highlights

- Countertop scale, ideally suitable for assisted sales, price labeling and cashing
- Easy Clean for quick and easy cleaning of the scale
 - Surface: problem-free removal of stray labels
 - Displays: frameless for ease of cleaning
- Weighing tray/pan: easy handling
- Easy Load enables label rolls to be changed in a matter of seconds
 - Combi-printer with receipt and linerless operation up to 80 mm paper roll widths
 - In addition label layout on pre-printed linerless paper possible
- Label printer
- Easy Level tilt compensation
 - Correct weight even at an angled position, no loss of sales
- High-end PC scale with outstanding Intel® Dual Core processor for optimum performance and perfect graphics with minimum power consumption
- Wake on LAN for more energy efficiency

Options

- Easy Level tilt compensation
- Dual printer
- Various weighing ranges
- Additional COM interface in conjunction with interface for cash drawer
- Cash register drawer
- WLAN
- Audio kit (internal speaker)
- High-end Bizerba software package
 - RetailPowerScale scale software
 - RetailApps for additional functionality
 - RetailFramework
 - RetailIntegratorsKit (RIK) for 3rd-party software

Dimensions

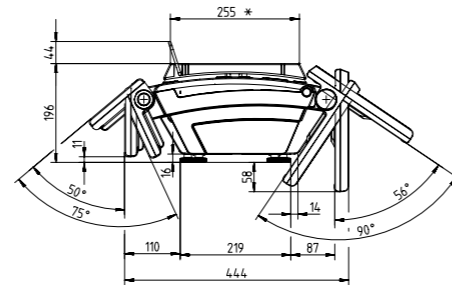
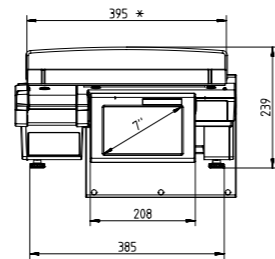
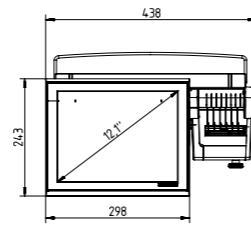

KH II 100 7" B (G)

Highlights

- Countertop scale, ideally suitable for the bread and bakery department (KH II 100 B)
- Counter top scale for goods receiving and commissioning (KH II 100 G)
- Easy Clean for quick and easy cleaning of the scale
 - Surface: problem-free removal of stray labels
 - Displays: frameless for ease of cleaning
- Easy Load enables label rolls to be changed in a matter of seconds
 - Combi-printer with receipt and linerless operation up to 80 mm paper roll widths
 - In addition label layout on pre-printed linerless paper possible
- Label printer
- High-end PC scale with outstanding Intel® Dual Core processor for optimum performance and perfect graphics with minimum power consumption
- Wake on LAN for more energy efficiency

Options

- Various weighing ranges
- Separate load receptor up to 150 kg (KH II 100 G)
- Additional COM interface in conjunction with interface for cash drawer
- Cash register drawer
- WLAN
- Audio kit (internal speaker)
- High-end Bizerba software package
 - RetailPowerScale scale software
 - RetailApps for additional functionality
 - RetailFramework
 - RetailIntegratorsKit (RIK) for 3rd-party software

Dimensions

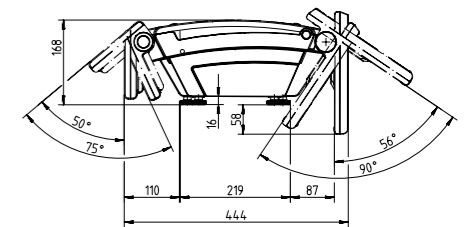
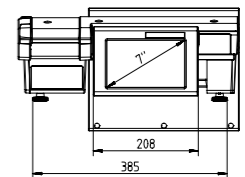
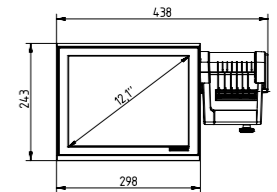

Perfect integration



The freedom to combine components, network functions and work ergonomically even in tight spaces: This is what our Flex solutions are capable of. Integrate the scale together with a slicer in your store concept. Gain more freedom thanks to unhindered access to the sales counter. Benefit from the multifunctionality to slice, weigh, provide service, label products, handle transactions or provide information. Also in the self-service area. In our opinion, that's the definition of perfect integration.

One modular design – many options



Multi-color customer display
TFT LCD with LED backlighting 7"



Multi-color customer display
TFT LCD with LED backlighting 2,1"



Multi-color operator display
TFT LCD with LED backlighting 12,1"



K-Class Flex printer



2" L compact printer



K-Class Flex CPU control unit



VESA mounting system



K-Class Flex scale
Type LA KF

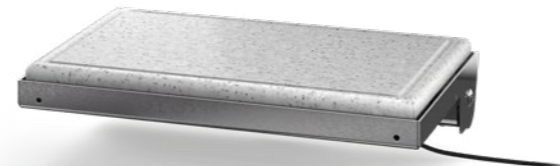

K-Class Flex ScalePad
Extra flat scale for integration in the service counter



K-Class Flex cash register drawer



K-Class Flex

Highlights

"Modular design" for various applications

- Scale
- Cash register
- Info terminal
- Easy Clean for quick and easy cleaning

Printer

- K-Class Flex printer
 - Receipt, linerless, paper width up to 80 mm, print speed up to 150 mm/s
 - Label
 - Dual printer
 - Easy Load enables paper rolls to be changed in a matter of seconds
- 2" L compact printer
 - Receipt, linerless, paper width 2" (58 mm), print speed up to 150 mm/s
 - Easy Load enables paper rolls to be changed in a matter of seconds
- EPSON printer
 - Receipt, paper width 80 mm, print speed up to 250 mm/s

Options

- Various customer displays
- Various printers
- VGA interface
- Cash register drawer
- WLAN
- Various weighing ranges
- RetailApps for additional functionality

- Front loader
- Easy load
- Cutter

CPU control unit Displays

- Operator color touch screen
 - TFT LCD with LED backlighting 12.1"
- Multi-color customer display
 - TFT LCD with LED backlighting 12.1"
 - TFT LCD with LED backlighting 7"

High-end Bizerba software package

- RetailPowerScale scale software
- RetailApps for additional functionality
- RetailFramework
- RetailIntegratorsKit (RIK) for 3rd-party software

VESA mounting system

- Display holder VESA Mount for operator and customer display
- Mounting arm for printer optional

Various load receptors

- Type KF
- Type 18 A
- Type 150
- ScalePad

Connection to slicer

- GSP H Flex
- VSC280 Flex

Color

- Anthracite
- White

Dimensions

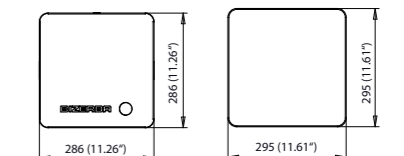
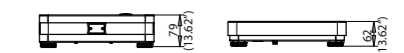
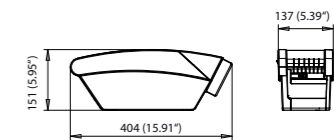
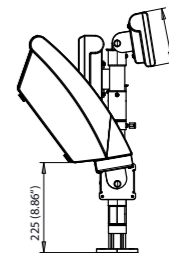
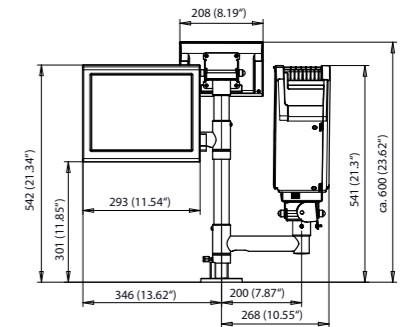



GSP H Flex

Highlights

- Metrologically approved combination of integrated PC scale K-Class Flex II and vertical slicer GSP H
- Multifunctional use:
 - Slicing, weighing, transactions, inventory, data maintenance, advising, informing, advertising/cross selling
- Flexible arrangement of components thanks to modular system
- Easy to integrate in sales counters
- VESA standard mounting system
- Efficient cleaning of all components
- Easy to change label rolls
- 40° angled blade and flexible carriage inclination (0°/18°/25°)
- Innovative blade cover: Intelligent quick-close system for easy assembly and disassembly
- Powerful Bizerba motor
- Numerous carriage versions available

Options

K-Class Flex II

- Customer display:
 - 12" or 7" LCD color display
- Printer versions:
 - Dual printer for 2" receipt and 2" linerless paper
 - Dual printer for 2" receipt and 3" label paper
 - Printer for 3" label paper
 - Printer for 3" receipt or linerless paper
 - 2" printer Linerless compact
 - Epson TM-T 70 II
- VGA interface
- WLAN

GSP H

- Exclusive Ceraclean® surface finish
- Excellent gliding properties
- Easy product guidance
- Rapid cleaning
- Dishwasher safe
- Individual equipment:
 - Blade: Ceraclean® blade, cheese blade, bread blade
 - Numerous carriage versions
 - Blade changing device
 - Blade cover
 - Product fixation device
 - Placement (rubber feet, lifting mechanism)
- Safety package:
 - Illumination: Visual display showing the current device mode
 - Automatic start/stop function via the slice thickness button

Dimensions

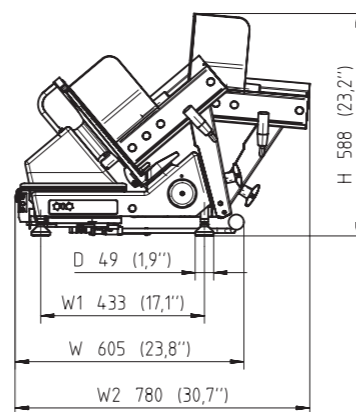
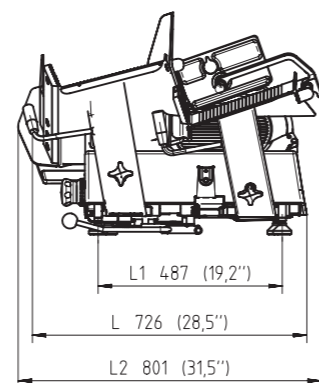

BIZERBA



VSC280 Flex

Highlights

- Metrologically approved combination of integrated PC scale K-Class Flex II and slicer VSC 280
- Multifunctional use:
 - Slicing, Weighing, Cashing, Inventory, Data management, Advising, Informing, Marketing/Cross Selling
- Flexible arrangement of components thanks to modular system
- Easy to integrate in sales counters
- VESA standard mounting system
- Low energy consumption thanks to high-end PC scale
- Efficient cleaning of all components
- Easy to change label rolls
- 10° blade angle: Optimum ergonomics, improved overall view
- Hygienic design:
 - One-piece machine housing and base plate
- High-quality Bizerba components and Ceraclean® surface
- Guided run-off of meat and product juices
- Removable, dishwasher-safe parts
- Large distance between blade and motor tower for easy cleaning by hand
- Innovative blade cover: Intelligent quick-close system for easy and safe assembly and disassembly
- Emotion®:
 - Intelligent drive technology
 - Reduced energy consumption
 - Zero energy consumption when switched off
 - Only minimal heat generated in the device and hence in the product
 - Very low noise level

Options

K-Class Flex II

- Customer display:
 - 12" LCD color display
 - 7" LCD color display
- Printer versions:
 - Dual printer for 2" receipt and 2" linerless paper
 - Dual printer for 2" receipt and 3" label paper
 - Printer for 3" label paper
 - Printer for 3" receipt or linerless paper
 - 2" printer Linerless compact
 - Epson TM-T 70 II
- Interfaces
- WLAN
- VGA

VSC280

- Individual equipment:
 - Blade: Ceraclean® blade, cheese blade (channeled), bread blade
 - Remnant holder: smooth, checked, with spikes
 - Carriage: one-piece, entirely made of aluminum or with transparent rear wall
 - Blade cover: open, closed
 - Product fixation device
- Installation: Rubber bars, feet

Dimensions

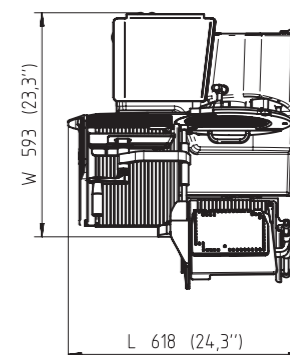
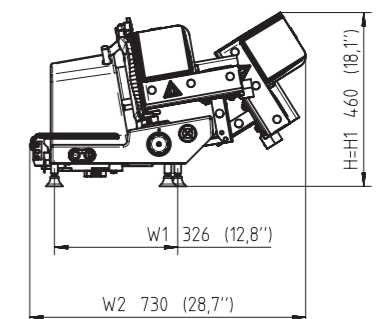
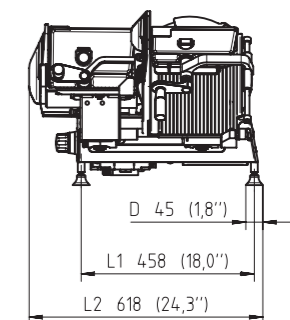

VSC280 Flex

All possibilities at a glance

	Ideal for							Application						Application area						Equipment				Options								
	Sausages/cold cuts	Meat	Cheese	Seafood	Fruit/vegetables	Bread/bakery department	Non-food	Counter service	Self-service	Weigh price labeling/pre-packaging	Goods receiving/commissioning	Multimedia applications	Cash register	Food trade	Food stores	Fine foods/delicatessen	Gastronomy/snack bars	Hardware stores	Mobile trading	Easy Clean Display	Easy Fit load platter	Easy Load Printer	Dual printer	Wake on Lan	Easy Level	Cash register interface	Separate load drawer up to 150 kg	K-Class Flex ScalePad	Connection to slicer	WLAN		
Counter scale with stand																																
KH II 800 with 7"	●	●	●	●	●	●	●	●	⊖	●	●	⊖	⊖	●	●	●	●	●	●	●	●	●	●	●	●	⊖	×	×	×	●		
KH II 800 with 12,1"	●	●	●	●	●	●	●	●	⊖	●	●	⊖	⊖	●	●	●	●	●	●	●	●	●	●	●	●	⊖	×	×	×	●		
KH II 800 TP	●	●	●	●	●	●	●	●	⊖	●	●	⊖	⊖	●	●	●	●	●	●	●	×	●	●	●	●	⊖	×	×	×	●		
KH II 800 with 12,1" SP	●	●	●	●	●	●	●	●	⊖	●	●	⊖	⊖	⊖	●	●	●	●	●	●	●	●	●	●	●	●	×	×	×	●		
KH II 800 SB	×	×	×	×	●	×	●	×	●	⊖	⊖	⊖	⊖	●	⊖	⊖	×	●	×	●	●	●	×	●	●	⊖	×	×	×	●		
KH II 800 SV	×	×	×	×	●	×	⊖	×	●	⊖	⊖	⊖	⊖	●	⊖	⊖	×	⊖	×	●	●	●	×	●	●	⊖	×	×	×	●		
Countertop scales																																
KH II 100 with 7"	●	●	●	●	●	●	●	●	⊖	●	●	⊖	●	●	●	●	●	●	●	●	●	●	●	●	●	●	×	×	×	●		
KH II 100 7" B	×	×	×	×	×	●	●	●	×	●	×	⊖	●	●	●	●	●	●	●	●	●	●	×	●	×	●	×	×	×	●		
KH II 100 7" G	⊖	⊖	⊖	⊖	●	●	●	●	⊖	●	●	⊖	●	●	●	⊖	●	●	●	●	●	●	×	●	×	●	●	×	×	●		
Countertop scale with customer display on a stand																																
KH II 200 with 7"	●	●	●	●	●	●	●	●	⊖	●	●	⊖	●	●	●	●	●	●	●	●	●	●	×	●	●	●	×	×	×	●		
KH II 200 with 12,1"	●	●	●	●	●	●	●	●	⊖	●	●	●	●	●	●	●	●	●	●	●	●	●	×	●	●	●	×	×	×	●		
Hanging scale																																
KH II 400 with 7"	⊖	⊖	⊖	●	●	⊖	⊖	●	⊖	●	⊖	⊖	●	●	●	●	⊖	⊖	⊖	●	×	●	●	●	×	⊖	×	×	×	●		
KH II 400 with 12,1"	⊖	⊖	⊖	●	●	⊖	⊖	●	⊖	●	⊖	●	●	●	●	●	⊖	⊖	⊖	●	×	●	●	●	×	⊖	×	×	×	●		
Scale for counter integration																																
K-Class Flex	●	●	●	●	●	●	●	●	●	●	●	●	●	●	●	●	●	●	●	×	×	●	●	●	×	●	●	●	●	●		

Key
 ● Optimally suitable for this purpose
 ⊖ Suitable for this purpose
 × Unsuitable for this purpose

For top quality and reliable performance

In your day-to-day work with the K-Class, you can rely on high-quality cleaning products and original consumables in Bizerba quality. Everything is perfectly matched to your products ensuring the best possible results and longevity of your investments. A perfect example of teamwork with added benefits for you.

Cleaning agents

Optimal functioning and constant availability of your devices and machines requires professional care. Our high quality cleaning agents play an important role here since they are specifically developed for demanding conditions in retail, industry and food service. They are easy to use and show impressive results: perfect cleanliness providing protection as well as disinfecting hygiene for sensible components and smooth surfaces. For each material whether stainless steel, plastic or glass, we have a suitable cleaning agent in our comprehensive assortment. Clean solutions for your work area or production facility.

Quality labels

Many functions using minimal space: Labels are an indicator for price and ingredients and communicate with industry, trade and end customers via barcodes, QR codes, RF and RFID tags. As a key component of the packaging they fulfill important marketing functions with regard to corporate design, brand names and product marketing. Furthermore, as a production factor, they have an impact on costs and feasibility in the manufacturing process. Our quality labels offer almost unlimited possibilities: ranging from the ecological, high-quality linerless version and thermal-sensitive labels which conform with the Food Information Regulation up to multi-functional labels for product and brand protection. Also here we produce in an economical and innovative manner. Ask for more information about our labels.



Service redefined My Bizerba



We offer you solutions from a single source which can be customized and allow you to respond to any change in a flexible manner. No matter which modules you are combining for your solution: You benefit from costs which can be planned and efficient processes. And in best Bizerba quality.

Products	Services	Contracts
<ul style="list-style-type: none"> - Hardware: - Software & Software Apps - Labels & Consumables - Cleaning & Care - Spare & Wear Parts 	<ul style="list-style-type: none"> - Consulting - Installation - Maintenance - On stand-by - Financing - Training 	<ul style="list-style-type: none"> - Service contracts - Smart contracts

Information to suit your every need

If you are looking for a fast and reliable way to find the right solutions for your company, there are various routes to the perfect result. Whether you would like to contact us online or prefer to arrange a face-to-face meeting, Bizerba is always happy to help.

In person

You personally want to inform yourself about solutions tailored to your local circumstances? Do not hesitate to contact us. Our customer advisors are always on hand to assist you. From the idea of planning measures up to the implementation and training, our customer service representatives are at your service. You can find details of how to contact us on the back page of this brochure.

packaging, pricing and labeling. Experience our solutions from all sides. Our solutions can be viewed virtually in a short video or 360° animation. Simply visit our website to see more:

www.bizerba.com

Would you like to learn more?

Are you keen to obtain more detailed information about Bizerba's products? If so, please contact us. Whether these are dimensional drawings, technical information or interface descriptions. We are happy to advise you.

Online

The Bizerba website provides a quick, easy and focused overview of all our product solutions as well as relevant topics relating to weighing,

Members of the Bizerba Group

Bizerba SE & Co. KG

Wilhelm-Kraut-Straße 65
72336 Balingen
Germany

T +49 7433 12-0
F +49 7433 12-2696
info@bizerba.com

www.bizerba.com

Bizerba USA Inc.

1804 Fashion Court
Joppa, MD 21085
USA

T Office +1 732 565-6000
T Service +1 732 565-6001
F +1 732 819-0429
us.info@bizerba.com

www.bizerbausa.com

Bizerba UK Limited

2-4 Erica Road
Stacey Bushes
Milton Keynes
Buckinghamshire
MK12 6HS

UK
T +44 1908 6827-40
F +44 1908 6827-77
sales@bizerba.co.uk

www.bizerba.com

Bizerba Canada Inc.

2810 Argentia Road #9
Mississauga,
Ontario L5N 8L2
Canada

T +1 905 816-0498
F +1 905 816-0497
ca.info@bizerba.com

www.bizerba.ca

Bizerba Shanghai

Weigh Tech & Systems Co. Ltd.

D-3, Qianpu Road,
Shuhui Real Est.Park
East New Area of Songjiang,
Ind. Zone
201611 Shanghai
China

T +86 21 676009-99
F +86 21 676009-98
marketing.china@bizerba.cn

www.bizerba.cn

I/805en © 4nd edition. Subject to modifications. 122017. Illustration Title: KH II 800 12.1"

Deviations in color, printing errors due to the photographic material or printing, or changes in construction and model are reserved.